

TYPICAL WIRING DIAGRAM

NOTES:

1. ALL UNITS ARE cUL LISTED AND DESIGNED ACCORDANCE WITH INDUSTRY STANDARDS.
2. TRANSFORMERS ARE DRY-TYPE, CLASS AA, ENCAPSULATED NEMA 3R ENCLOSED FOR INDOOR / OUTDOOR USE.
3. TRANSFORMERS ARE WALL / MACHINE MOUNTABLE VIA THE ATTACHED BRACKETS.
4. TRANSFORMERS ARE CONSTRUCTED BASED UPON A 40°C AMBIENT ENVIRONMENT.
5. MAINTAIN 1" CLEARANCE FROM ALL LIVE PARTS.
6. PAINT COLOR IS ANSI# 61.

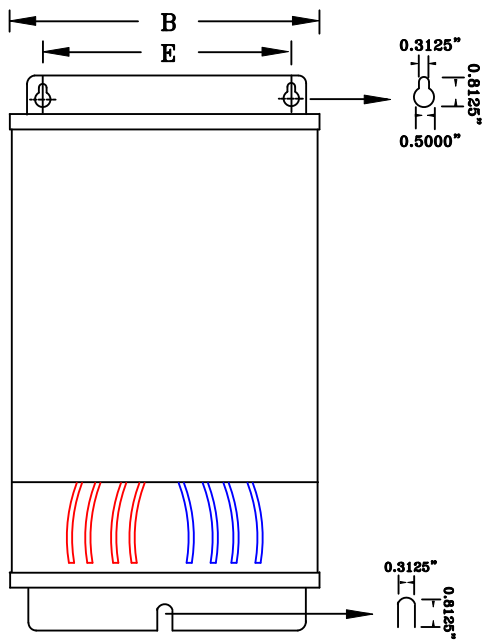

FRONT VIEW

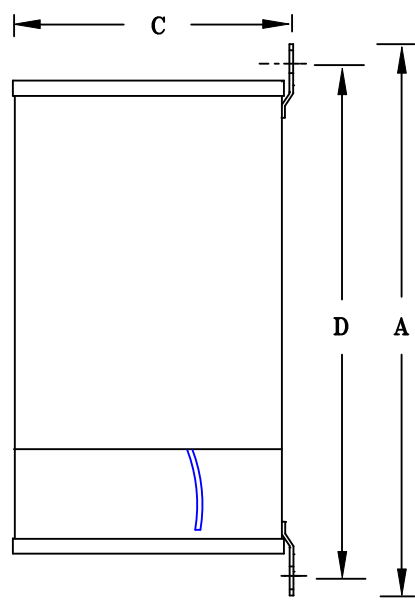

SIDE VIEW

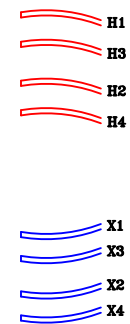

TERMINAL VIEW

APPROXIMATE DIMENSIONS (INCHES)

| KVA | A | B | C | D | E | F | HARDWARE | MTG SLOTS | ENCLOSURE | lbs. | WEATHER SHIELD | TERMINAL TYPE |
|-------|------|------|------|------|------|------|----------|-----------------|-----------|------|----------------|---------------|
| 0.250 | 9.25 | 4.00 | 5.00 | 8.50 | 2.00 | ---- | 1/4-20 | 0.312" x 0.812" | FPT-150 | 15 | N/A | LEADs |

* ELECTROSTATIC SHIELD GROUNDED TO TRANSFORMER CASE AT FACTORY (IF APPLICABLE)

| |
|--|
| DRAWINGS |
| <input checked="" type="checkbox"/> APPROVAL |
| <input type="checkbox"/> RECORD |
| <input type="checkbox"/> OTHER |

| | | | |
|------------------------|--|-----------|---|
| PRIMARY VOLTAGE | 240 x 480 | CUST. | XXXXXXXX |
| SECONDARY VOLTAGE | 120 x 240 | JOB | |
| TEMPERATURE RISE IN °C | 115 | CATALOG | |
| WINDINGS & TERMINALS | <input type="checkbox"/> ALUMINUM <input checked="" type="checkbox"/> COPPER | NOTE | XXXXXXXX |
| FREQUENCY HERTZ | 60 | BY | ENG. LOG. TITLE 1-PHASE, 600 VOLT CLASS ISOLATION DRY TYPE TRANSFORMER |
| PRIMARY TAPS | NONE | DATE | |
| POWERTRAN | REV | MFG. LOG. | DWG. NO. |
| | DATE: | DWG. FILE | PTN102-250 |